



Fixing type

Hexagonally countersunk bore for fixing with bolts from above.

Material

Nylon

Standard handle colour

Black

Caps

Black caps to conceal fixing head.

Finish

Matt

Thread

Hexagonally countersunk moulded bore

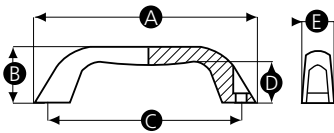

Part No.	A	B	C	D	Bore size (mm)
12556R	112	38	92	22	5.3
12557Y	141	38	120	24	5.3
12558U	168	44	145	28	6.5