

**Material**

High impact resistant thermoplastic

**Standard colour**

Black

**Finish**

Matt

**Male thread material**

Zinc plated steel or stainless steel

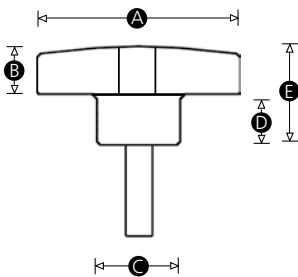

Part No.	A	B	C	D	E	Thread size	Thread length (mm)	Thread material
9150X	38	11	16	12	23	M6	20	Zinc plated steel
14331Q	38	11	16	12	23	M6	25	Zinc plated steel
14344T	38	11	16	12	23	M6	25	Stainless steel
14332X	38	11	16	12	23	M8	20	Zinc plated steel
9148U	38	11	16	12	23	M6	30	Zinc plated steel
14345P	38	11	16	12	23	M8	20	Stainless steel
14333T	38	11	16	12	23	M8	30	Zinc plated steel
14346W	38	11	16	12	23	M8	30	Stainless steel
9147Y	50	12	20	15	27	M8	20	Zinc plated steel
14334P	50	12	20	15	27	M8	25	Zinc plated steel
14347S	50	12	20	15	27	M8	25	Stainless steel
9145V	50	12	20	15	27	M8	30	Zinc plated steel
14335W	60	14	24	15	29	M10	25	Steel
14348Z	60	14	24	15	29	M10	25	Stainless steel

Continued on facing page »

« Continued from facing page

Part No.	A	B	C	D	E	Thread size	Thread length (mm)	Thread material
9143S	60	14	24	15	29	M10	30	Zinc plated steel
9142W	60	14	24	15	29	M10	40	Zinc plated steel
14336S	60	14	24	15	29	M12	30	Zinc plated steel