

HD 

**Fixing type**

Plain bores for fixing with bolts from above.

**Material**

Nylon

**Thread**

Moulded bore

**Info**

This heavy duty handle features a flat edge with protuding areas for extra grip. When mounted on a wall or vertical surface it is suitable for a foot step application.

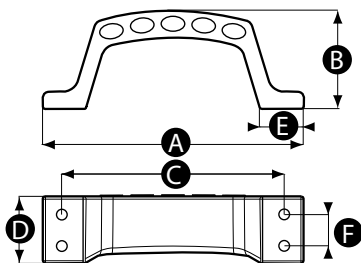

Part No.	A	B	C	D	E	F	Bore size (mm)
12561T	162	63.5	140	42	27	20	6.5